

QFP

QUAD FLAT  
PACKAGE

Applicable IC/QFP • TQFP • MQFP • CQFP

## CLAM SHELL TYPE SOCKETS

### ORDERING PROCEDURE

FPQ - [            ] - [            ] - [            ]

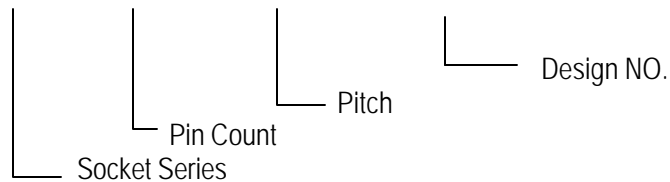

### SPECIFICATIONS

Contact resistance: Initial 30m $\Omega$  (At 10mA)  
Maximum voltage: AC700V RMS (for 1 minute)  
                          \* Below 0.5mm Pitch  
                          AC500V RMS (for 1 minute)  
Insulation resistance: 1,000M $\Omega$  or higher (At DC 500V)  
Rated current: 1A  
Operating temperature range: -60°C ~ +150°C  
Terminal strength against pulling: 0.5kg (1 minute)  
Insertion: Min. 10,000 times (Mechanical)

### MATERIAL

Body: PPS, PEI or PES  
Contact: BeCu, SnNiCu plating (Ni-base)

## APPLICABLE IC DIMENSIONS & SOCKET DIMENSIONS

### FINE PITCH QFP (0.4mm Pitch)

Unit: mm (in.)

PART NO.	PIN COUNT	PITCH	APPLICABLE IC DIMENSIONS (REF.)			REMARKS
			A	B	C	
FPQ-80-0.4-01	80	0.4 (15.7mil)	10X10 (0.394X0.394)	11X11 (0.433X0.433)	12X12 (0.472X0.472)	Floating second cover
FPQ-120(128)-0.4-01	120	0.4 (15.7mil)	14X14 (0.551X0.551)	15X15 (0.590X0.590)	16X16 (0.629X0.629)	Floating pedestal
FPQ-120(128)-0.4-02	120	0.4 (15.7mil)	13.94X13.94 (0.545X0.545)	15X15 (0.590X0.590)	16X16 (0.629X0.629)	Floating second cover
FPQ-128-0.4-02	128	0.4 (15.7mil)	max 14.5X14.5 (0.570X0.570)	15X15 (0.590X0.590)	16X16 (0.629X0.629)	Floating pedestal
FPQ-144-0.4-01	144	0.4 (15.7mil)	16X16 (0.629X0.629)	17X17 (0.669X0.669)	18X18 (0.708X0.708)	Floating second cover
FPQ-176(184)-0.4-01	176	0.4 (15.7mil)	20X20 (0.787X0.787)	21X21 (0.826X0.826)	22X22 (0.866X0.866)	Floating pedestal
FPQ-184-0.4-01	184	0.4 (15.7mil)	20X20 (0.787X0.787)	21X21 (0.826X0.826)	22X22 (0.866X0.866)	Floating pedestal
FPQ-216-0.4-03	216	0.4 (15.7mil)	24X24 (0.944X0.944)	25X25 (0.984X0.984)	26X26 (1.024X1.024)	Floating second cover
FPQ-256-0.4-02	256	0.4 (15.7mil)	28X28 (1.102X1.102)	29.6X29.6 (1.165X1.165)	30.6X30.6 (1.204X1.204)	Floating pedestal
						Short Lead
FPQ-256-0.4-03	256	0.4 (15.7mil)	28X28 (1.102X1.102)	29.4X29.4 (1.158X1.158)	31.2X31.2 (1.228X1.228)	Floating pedestal
						Long Lead
FPQ-376-0.4-02	376	0.4 (15.7mil)	40X40 (1.675X1.675)	41.6X41.6 (1.638X1.638)	42.6X42.6 (1.677X1.677)	Floating second cover

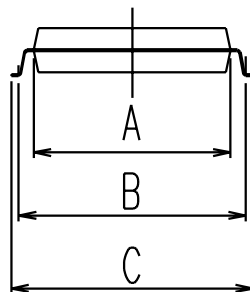
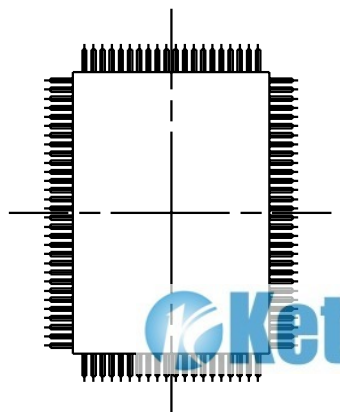
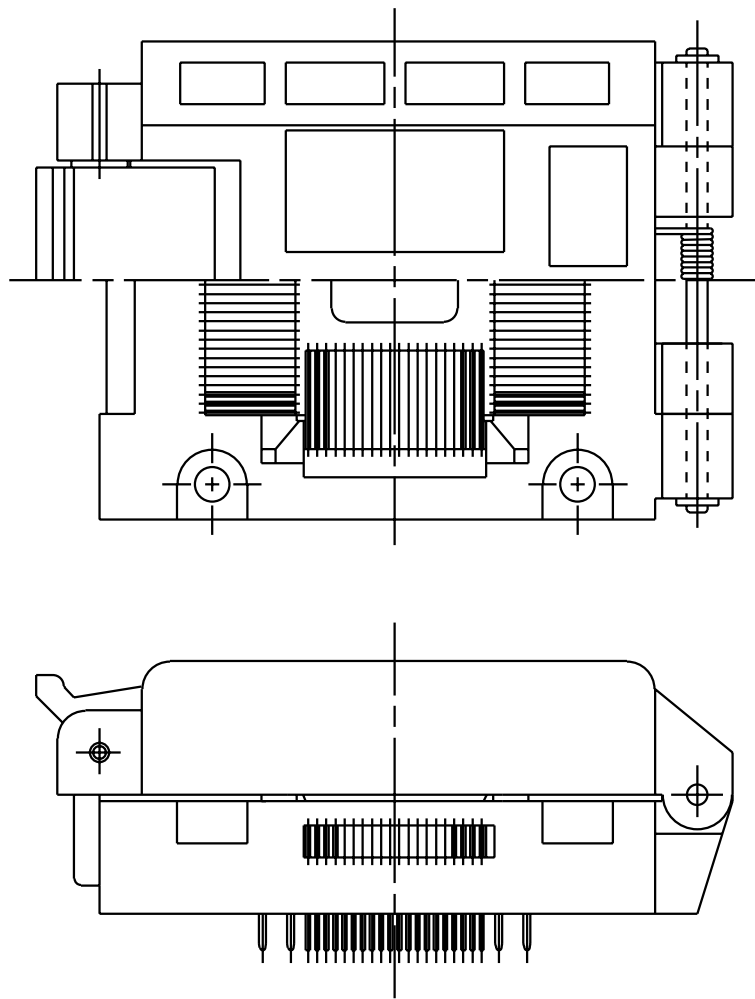

FPQ-100-0.65  
(REFERENCE ONLY)

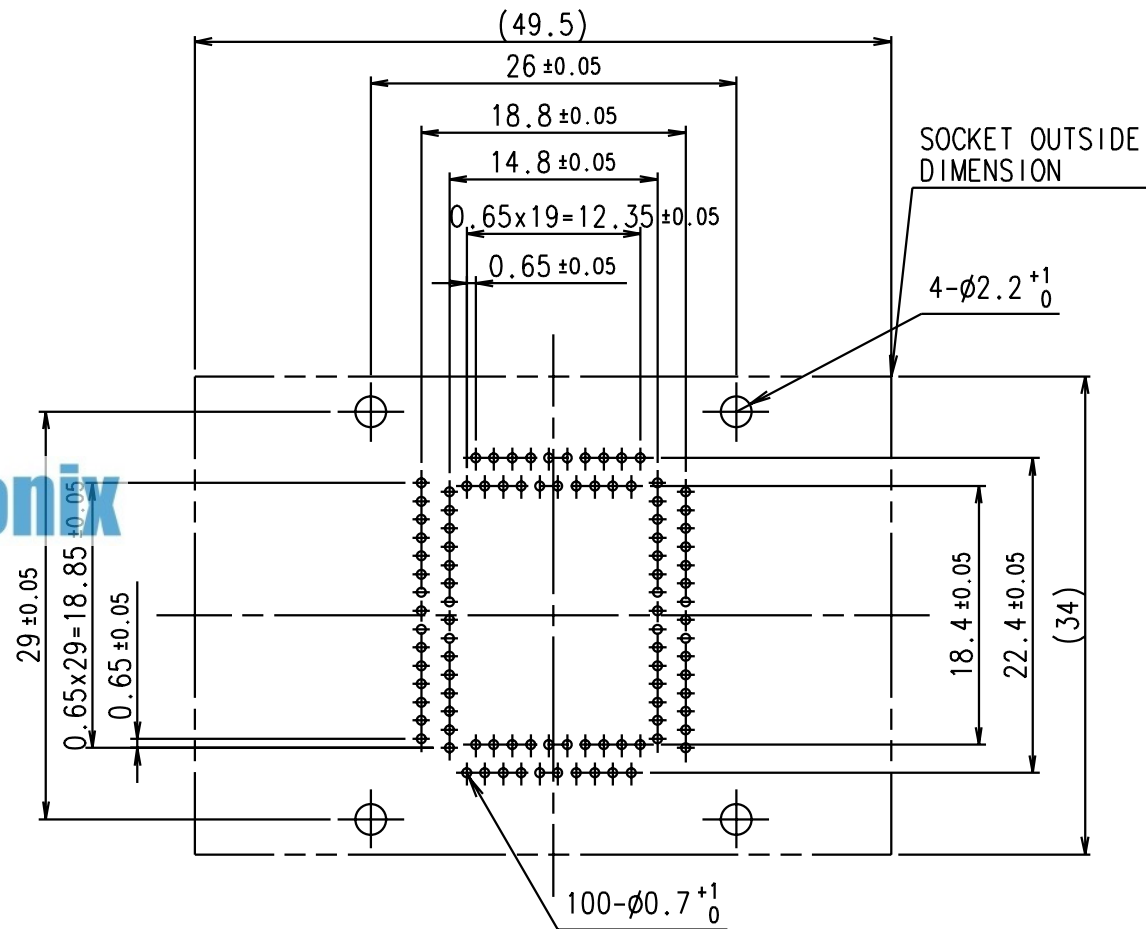

FPQ-100-0.65  
(REFERENCE ONLY)