

QFP

QUAD FLAT
PACKAGE

Applicable IC/QFP • TQFP • MQFP • CQFP

CLAM SHELL TYPE SOCKETS

ORDERING PROCEDURE

FPQ - () - () - ()

Socket Series Pin Count Pitch Design NO.

Ketronix



SPECIFICATIONS

Contact resistance: Initial 30m Ω (At 10mA)
Maximum voltage: AC700V RMS (for 1 minute)
* Below 0.5mm Pitch
AC500V RMS (for 1 minute)
Insulation resistance: 1,000M Ω or higher (At DC 500V)
Rated current: 1A
Operating temperature range: -60°C ~ +150°C
Terminal strength against pulling: 0.5kg (1 minute)
Insertion: Min. 10,000 times (Mechanical)

MATERIAL

Body: PPS, PEI or PES
Contact: BeCu, SnNiCu plating (Ni-base)

www.ketronix.com

APPLICABLE IC DIMENSIONS & SOCKET DIMENSIONS

TQFP (2.0 mm Forming)

Unit: mm (in.)

| PART NO. | PIN COUNT | PITCH | APPLICABLE IC DIMENSIONS (REF.) | | | REMARKS |
|-----------------|-----------|------------------|---------------------------------|----------------------------|------------------------|-----------------------|
| | | | A | B | C | |
| FPQ-32-0.8-01 | 32 | 0.8 (32mil) | 7X7 (0.275X0.275) | 8X8 (0.315X0.315) | 9X9 (0.354X0.354) | with Floating |
| FPQ-44-0.8-19 | 44 | 0.8 (32mil) | 10X10 (0.394X0.394) | 11X11 (0.433X0.433) | 12X12 (0.472X0.472) | with Floating |
| FPQ-44-1.0-04D | 44 | 1.0 (39mil) | 14X14 (0.551X0.551) | 15X15 (0.590X0.590) | 16X16 (0.630X0.630) | |
| FPQ-48-0.5-06 | 48 | 0.5 (19.6mil) | 7X7 (0.275X0.275) | 8X8 (0.315X0.315) | 9X9 (0.354X0.354) | with Floating |
| FPQ-64-0.5-06 | 64 | 0.5 (19.6mil) | 10X10 (0.394X0.394) | 11X11 (0.433X0.433) | 12X12 (0.472X0.472) | with Floating |
| FPQ-72-0.5-01 | 72 | 0.5 (19.6mil) | 10X10 (0.394X0.394) | 11X11 (0.433X0.433) | 12X12 (0.472X0.472) | with Floating |
| FPQ-80-0.5-04 | 80 | 0.5 (19.6mil) | 12X12 (0.472X0.472) | 13X13 (0.512X0.512) | 14X14 (0.551X0.551) | with Floating |
| FPQ-80-0.5-07 | 80 | 0.5 (19.6mil) | 12.4X12.4 (0.488X0.488) | 13.2X13.2 (0.519X0.519) | 14X14 (0.551X0.551) | with Floating |
| FPQ-80-0.65-09A | 80 | 0.65 (26mil) | 14X14 (0.551X0.551) | 15X15 (0.590X0.590) | 16X16 (0.630X0.630) | with Floating |
| FPQ-100-0.5-10A | 100 | 0.5 (19.6mil) | 14X14 (0.551X0.551) | 15X15 (0.590X0.590) | 16X16 (0.630X0.630) | with Floating |
| FPQ-100-0.5-14 | 100 | 0.5 (19.6mil) | 14X14 (0.551X0.551) | 15X15 (0.590X0.590) | 16X16 (0.630X0.630) | Floating second cover |

| PART NO. | PIN COUNT | PITCH | APPLICABLE IC DIMENSIONS (REF.) | | | REMARKS |
|---------------------|-----------|------------------|---------------------------------|----------------------------|------------------------|-----------------------|
| | | | A | B | C | |
| FPQ-120(128)-0.5-05 | 120 | 0.5 (19.6mil) | 16.5X16.5 (0.650X0.650) | 17X17 (0.669X0.669) | 18X18 (0.709X0.709) | with Floating |
| FPQ-128-0.5-08 | 128 | 0.5 (19.6mil) | 14.4X20.4 (0.566X0.803) | 15.1X21.1 (0.594X0.830) | 16X22 (0.630X0.866) | with Floating |
| FPQ-144-0.5-03 | 144 | 0.5 (19.6mil) | 20X20 (0.787X0.787) | 21X21 (0.826X0.826) | 22X22 (0.866X0.866) | Floating second cover |
| FPQ-208-0.5-10 | 208 | 0.5 (19.6mil) | 28X28 (1.102X1.102) | 29X29 (1.142X1.142) | 30X30 (1.181X1.181) | Floating second cover |



www.ketronix.com

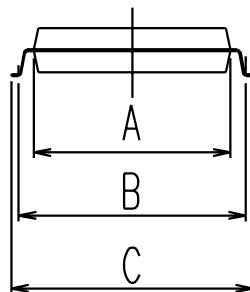
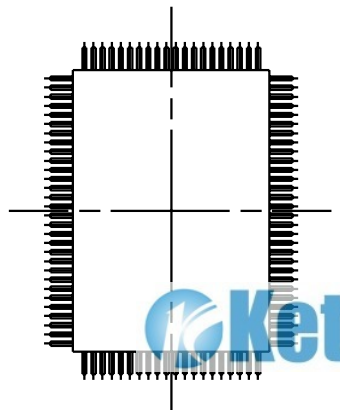
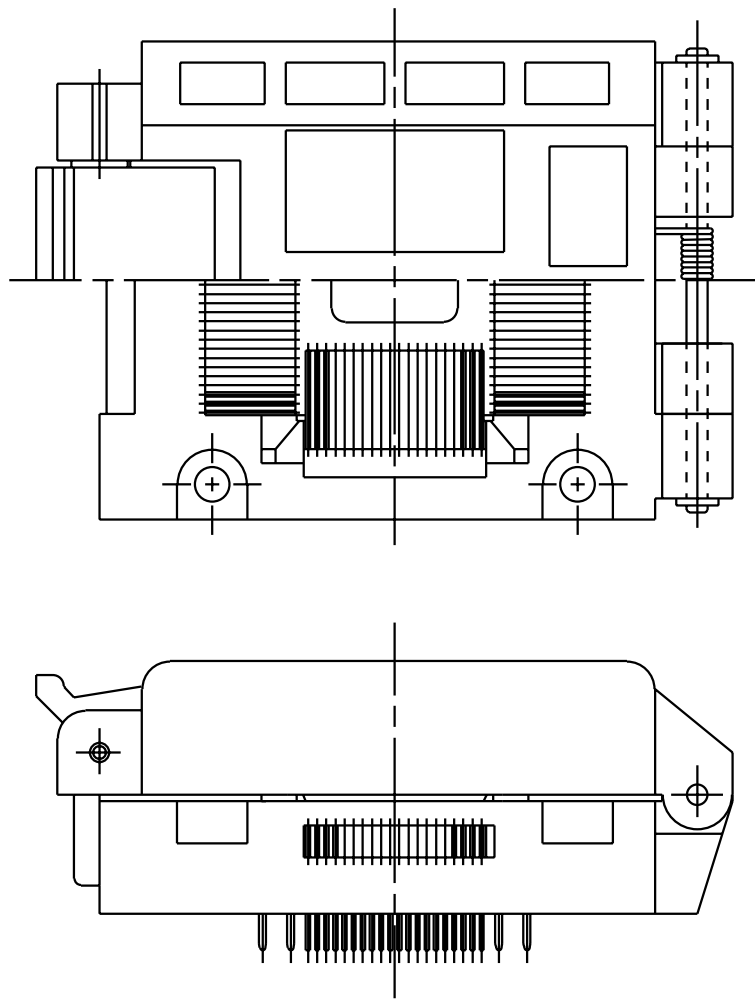

FPQ-100-0.65
(REFERENCE ONLY)

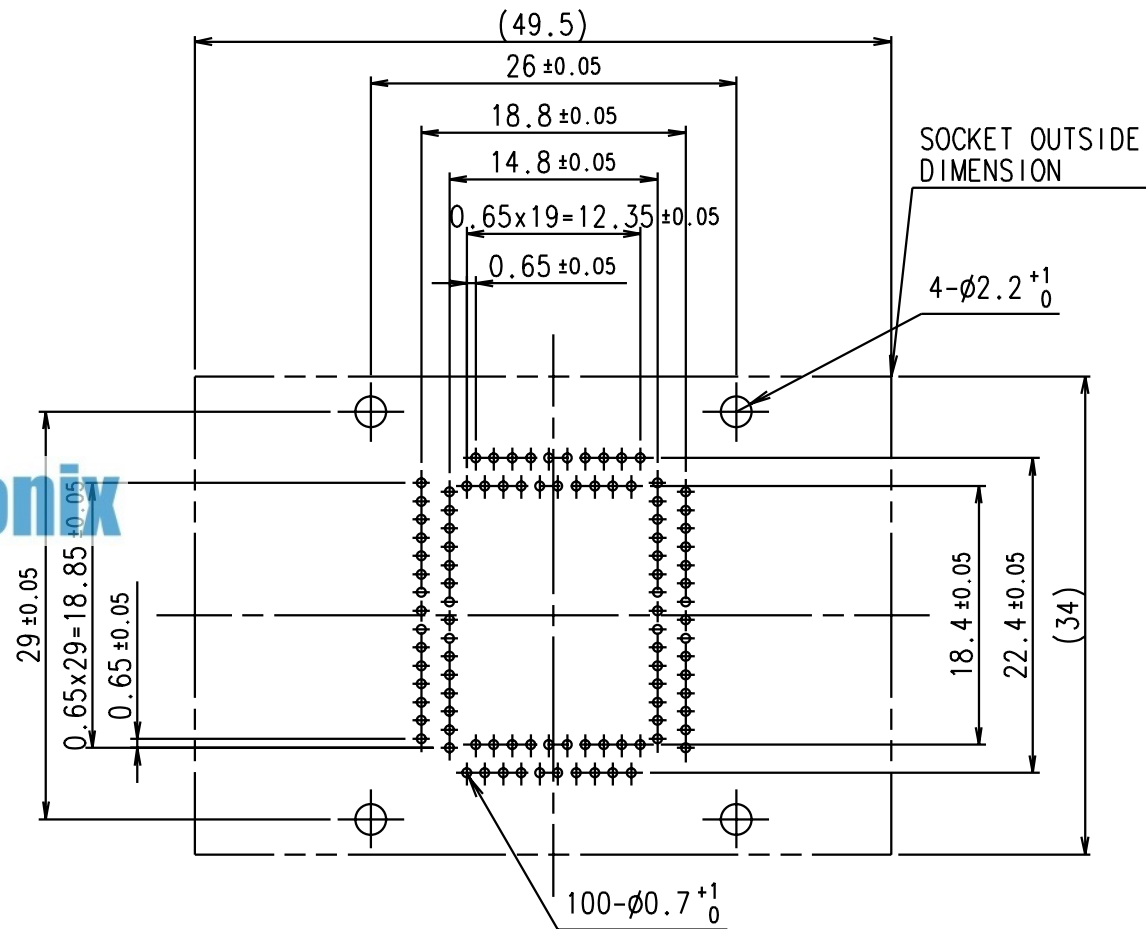

FPQ-100-0.65
(REFERENCE ONLY)